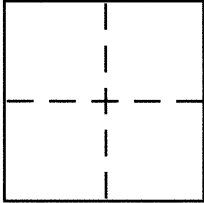

CORNER RECORDDocument Number CR 8269City of San Leandro County of Alameda, CaliforniaBrief Legal Description Monument along Dartmouth near 1215**CORNER TYPE**

Government Corner ☐ Control ☒
 Meander ☐ Property ☐
 Rancho ☐ Other ☐
 Date of Survey _____

COORDINATES (Optional)

N. 2082020.019
 E. 6082035.697
 Zone _____ NAD27 ☐ NAD83 ☒
 NAD83 Epoch _____
 Elev. _____
 Vert. Datum: NGVD29 ☐ NAVD88 ☐
 Meas. Units: Metric ☐ Imperial ☒

Corner – Left as found ☒ Found and tagged ☐ Established ☐ Reestablished ☐ Rebuilt ☐

Identification and type of corner found: Evidence used to identify or procedure used to establish or reestablish the corner:

Per section 8771b of the Business and Professions Code
This monument was referenced prior to a construction project in the vicinity

A description of the physical condition of the monument as found and as set or reset: _____

Found in good condition

SURVEYOR'S STATEMENT

This Corner Record was prepared by me or under my direction in conformance with the Land Surveyor's Act on April 9, 2016

Signed Joseph M. Brajkovich P.L.S. or R.C.E. No. 5254

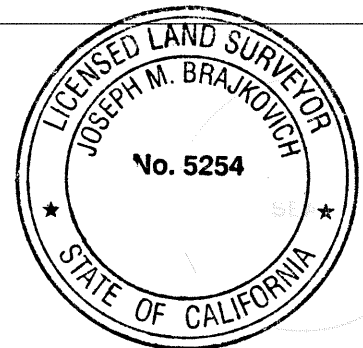
**COUNTY SURVEYOR'S STATEMENT**

This Corner Record was received 15 APRIL, 2016

and examined and filed 4 MAY, 2016

Signed Michael Rubner P.L.S. or R.C.E. No. 6843

Title County Surveyor

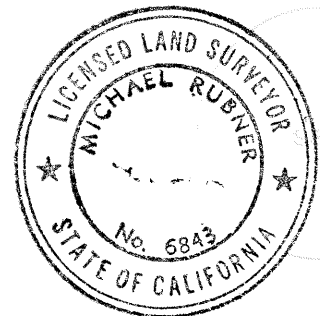

County Surveyor's Comment _____

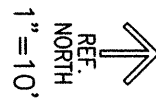

LEGEND

- MONUMENT
- CUT-X

DARTMOUTH AVENUE

MONUMENT

