

CORNER RECORD

Agency Index BK 131 PG 88
Document Number CR 14050
County of Alameda, California
Brief Legal Description B0433 City Monument at Intersection of Prospect St. & Bancroft Wy.

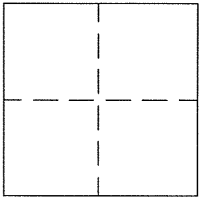

CORNER TYPE

Government Corner ☐ Control ☒
Meander ☐ Property ☐
Rancho ☐ Other ☐

Date of Survey 10/17/2019

COORDINATES (Optional)

N: _____ E: _____
Elevation: 100.09' (B0433)
Units: Metric ☐ U.S. Survey Foot ☒
Horizontal Datum _____
Zone _____ Epoch Date _____
Vertical Datum ASSUMED

☐ Complies with Public Resources Code §§ 8801-8819
☐ Complies with Public Resources Code §§ 8890-8902

PLS Act Ref: ☐ 8765(d) ☒ 8771 ☐ 8773 ☐ Other: _____
Corner/Monument: ☐ Left as found ☒ Established ☐ Rebuilt ☐ Pre-Construction
☐ Found and tagged ☐ Reestablished ☒ Referenced ☒ Post-Construction

Narrative of corner identified and monument as found, set, reset, replaced, or removed:
☒ See sheet #2 for description(s): B0433-FOUND(1) 2" BRASS CAP STAMPED "CITY OF BERKELEY" IN MONUMENT WELL. SET PUNCH MARK IN EDGE OF FOUND BRASS CAP PER CORNER RECORD 12847. REFERENCE TIES WERE FOUND, SET & MEASURED TO PERPETUATE EXISTING MONUMENT PURSUANT TO THE PLS ACT SECTION 8771 AFTER CONSTRUCTION. NO CLAIM IS MADE REGARDING THE CORRECTNESS OF THE POSITIONS OF SAID MONUMENTS, NOR THE DIMENSIONAL RELATIONSHIP TO STREET CENTERLINES OR PROPERTY BOUNDARIES. ALL LINE & CURVE DATA SHOWN IS MEASURED UNLESS OTHERWISE NOTED.

SURVEYOR'S STATEMENT

This Corner Record was prepared by me or under my direction in conformance with the Professional Land Surveyors' Act on November 18th, 2019.
Signed Mark E. Reinhardt P.L.S. No. 6392



COUNTY SURVEYOR'S STATEMENT

MAR 24 2020

This Corner Record was received _____, _____
and examined and filed **MAR 24 2020**
Signed D. Ian Wilson P.L.S. or R.C.E. No. 7010
Title **ALAMEDA COUNTY SURVEYOR**

County Surveyor's Comment



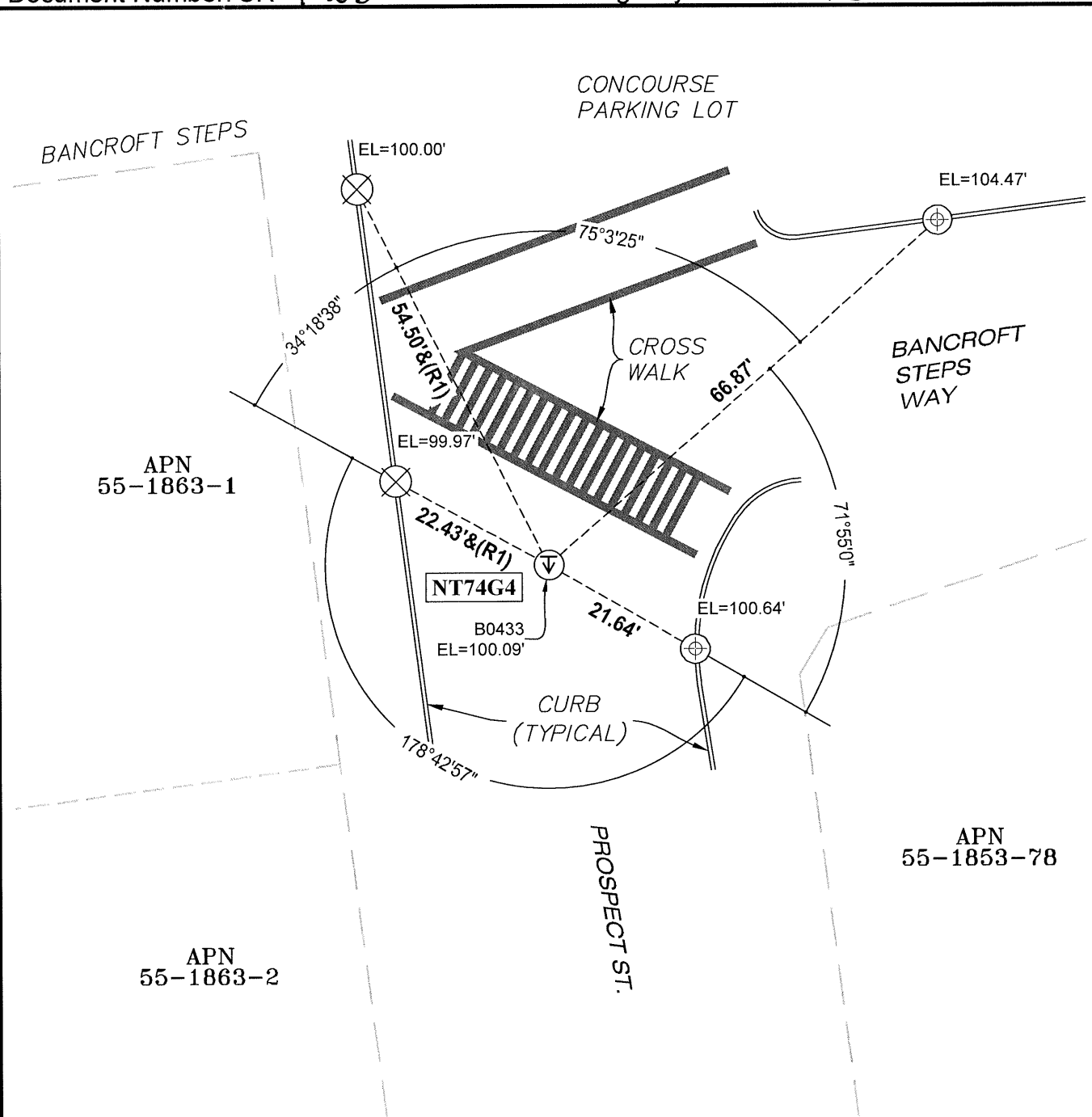

LEGEND

MONUMENT FOUND

Ⓢ (B0433) 2" BRASS CAP STAMPED "CITY OF BERKELEY" IN MONUMENT WELL

REFERENCE TIE FOUND

⊗ 1-1/4" BRASS DISK MARKED "PLS 6392" IN CURB per (R1)

REFERENCE TIE SET

⊕ 1-1/4" BRASS DISK MARKED "PLS 6392" IN CURB

NOTES

Elevations on reference points were established using a Sokkia B20 Automatic 32X level.

REFERENCE

(R1) Corner Record 12847

AA##A# - ALAMEDA COUNTY MONUMENT ID

All line & curve data shown is measured unless otherwise noted.

