

PARCEL MAP No. 2828

for

GARY L. HAWKINS and JOAN HAWKINS
1996002084

BEING A PORTION OF THE SE 1/4 SECTION 18, T. 7 N., R. 10 E., M. D. M.
COUNTY OF AMADOR, STATE OF CALIFORNIA

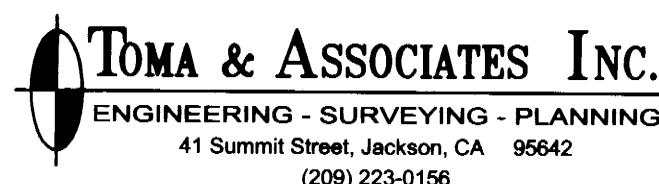

June, 2013

OWNER'S CERTIFICATE

THE UNDERSIGNED HEREBY CERTIFIES THAT THEY ARE THE OWNERS OF REAL PROPERTY SHOWN HEREON AS THE SUBDIVISION AND THAT THEY DO HEREBY CONSENT TO THE PREPARATION AND RECORDATION OF THIS MAP AND IN CONSIDERATION FOR AND AS A CONDITION OF THE APPROVAL OF SAID MAP THEY DO HEREBY:

1. MAKE AN IRREVOCABLE OFFER TO DEDICATE TO THE PUBLIC FOR ITS USE AND CONVENIENCE EASEMENTS FOR USE AS A PUBLIC HIGHWAY OVER EACH AND EVERY PART OF SAID SUBDIVISION DESIGNATED AS "30' ACCESS AND PUBLIC UTILITY EASEMENT", AND "LATROBE ROAD" AND "ACCESS AND PUE AREA"; AND
2. MAKE AN IRREVOCABLE OFFER TO DEDICATE TO THE PUBLIC FOR ITS USE AND CONVENIENCE AS A PUBLIC UTILITY EASEMENT IN, ON, OVER, ABOVE OR UNDER EACH AND EVERY PART OF SAID SUBDIVISION DESIGNATED ON THIS MAP AS A "ROAD AND UTILITY EASEMENT" OR "PUBLIC UTILITY EASEMENT" (P.U.E.) OR "ACCESS EASEMENT" AND ON, OVER, ACROSS AND THROUGH THOSE STRIPS OF LAND LYING FIVE FEET ON EACH SIDE OF ALL SIDE LOT LINES AND REAR LOT LINES AND TEN FEET ALONG THE EXTERIOR BOUNDARIES OF THIS SUBDIVISION AND FRONT LOT LINES, AN EASEMENT FOR SAID COUNTY OR ITS DESIGNEES AT ANY TIME, OR FROM TIME TO TIME, TO ENTER, CONSTRUCT, MAINTAIN, OPERATE, REPLACE, RENEW, ENLARGE AND PROTECT FROM HAZARDS SANITARY SEWERS, STORM DRAINS, LINES OR PIPES, CONDUITS, CABLES, WIRES, POLES AND NECESSARY FIXTURES AND EQUIPMENT THEREFOR, TO CONNECT ANY PUBLIC UTILITY SERVICE TO ANY PARCEL OR LOT INSIDE OR OUTSIDE OF SAID SUBDIVISION AND/OR TO ANY MAIN OR TRUNK LINE OR SYSTEM; AND
3. PROMISE, COVENANT AND AGREE TO AND WITH SAID COUNTY TO GRANT OR RESERVE A NON-EXCLUSIVE EASEMENT FOR INGRESS AND EGRESS OVER ALL THAT PORTION OF LAND DESIGNATED AS A "ROAD AND UTILITY EASEMENT" OR "ACCESS EASEMENT" TO THE RECORD OWNERS OF EACH LOT OR PARCEL IN SAID SUBDIVISION AT SUCH TIME AS SAID LOTS ARE SOLD OR FEE TITLE CONVEYED AND THAT NONE OF SAID LOTS SHALL BE LEASED, SOLD OR CONVEYED UNLESS SUCH NON-EXCLUSIVE EASEMENT FOR ROAD PURPOSES AND INGRESS AND EGRESS IS GRANTED OR RESERVED PRIOR TO OR CONCURRENT WITH SAID CONVEYANCE OR SALE (UNLESS SAID PORTION OF LAND HAS BEEN DEDICATED TO AND ACCEPTED BY SAID COUNTY AS A PUBLIC HIGHWAY) SO AS TO PROVIDE ACCESS FOR SAID OWNERS AND THEIR AGENTS, EMPLOYEES, INVITEES AND LICENSEES BETWEEN AND AMONG ALL OF SAID PARCELS OR LOTS WITHIN SAID SUBDIVISION; AND
4. MAKE AN IRREVOCABLE OFFER TO DEDICATE TO THE PUBLIC FOR ITS USE AND CONVENIENCE EASEMENTS FOR RIGHT-OF-WAY AND UTILITY MAINTENANCE FIVE FEET WIDE OUTSIDE OF AND CONTIGUOUS TO ALL CUT AND FILL SLOPES OF ALL ROADS OFFERED FOR DEDICATION SHOWN HEREON, FOR THE EXPRESS PURPOSE OF COUNTY'S OR OTHER AUTHORITY'S PERFORMING ALL NECESSARY WORK TO PROTECT THE ROADWAY AND MAINTAIN THE SLOPES. THE PORTIONS HEREON COVERED BY SAID EASEMENTS SHALL BE KEPT CLEAR.

SAID OFFERS TO DEDICATE AND AGREEMENTS AND COVENANTS ARE IRREVOCABLE AND SHALL RUN WITH THE LAND AND BE BINDING UPON ANY FUTURE OWNERS, ENCUMBRANCERS, SUCCESSORS, HEIRS OR ASSIGNS AND SHALL CONTINUE IN EFFECT UNTIL EXPRESSLY AND LAWFULLY ABANDONED AND TERMINATED BY THE BOARD OF SUPERVISORS OF SAID COUNTY. SAID BOARD, IN REJECTING ANY AND ALL OF SAID OFFERS TO DEDICATE, SHALL RETAIN THE RIGHT TO ACCEPT BY RESOLUTION ANY OR ALL OF SAID OFFERS AT ANY TIME HEREAFTER.

[Signature]
GARY L. HAWKINS

[Signature]
JOAN HAWKINS

[Signature]
MORTGAGE ELECTRONIC REGISTRATION
SYSTEM, INC., as nominee for
FIRST HORIZON HOME LOAN CORPORATION
Beneficiary per 20070004233
by *[Signature]*
Trish Aberle
Assistant Secretary

SURVEYOR'S STATEMENT

THIS SURVEY WAS PREPARED BY ME OR UNDER MY DIRECTION AND IS BASED UPON A FIELD SURVEY IN CONFORMANCE WITH THE REQUIREMENTS OF THE SUBDIVISION MAP ACT AND LOCAL ORDINANCE AT THE REQUEST OF GARY L. HAWKINS IN DECEMBER OF 2010. I HEREBY STATE THAT THIS PARCEL MAP SUBSTANTIALLY CONFORMS TO THE CONDITIONALLY APPROVED TENTATIVE MAP, THAT THE MONUMENTS ARE OF THE CHARACTER AND OCCUPY THE POSITIONS INDICATED, AND THAT SAID MONUMENTS ARE SUFFICIENT TO ENABLE THE SURVEY TO BE RETRACED.

DATE: September 17, 2013

[Signature]
CIRO L. TOMA P.L.S. 3570
MY LICENSE EXPIRES 6-30-2014

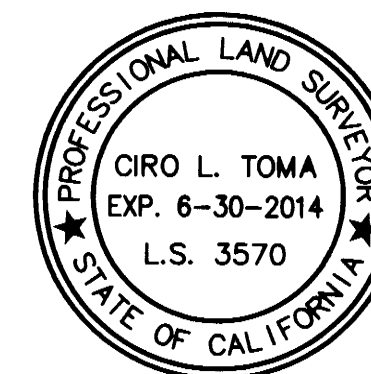

CLERK of the BOARD of SUPERVISOR'S CERTIFICATE

I, JENNIFER BURNS, HEREBY CERTIFY THAT I AM THE CLERK OF THE BOARD OF SUPERVISORS OF AMADOR COUNTY, CALIFORNIA, AND THAT THE BOARD, BEING THE PROPER APPROVING BODY, HAS ACCEPTED PARCEL MAP No. 2828 AND ACCEPTS ON BEHALF OF THE PUBLIC ALL LANDS AND EASEMENTS SHOWN HEREON AND OFFERED FOR DEDICATION FOR LIGHT, AIR AND PUBLIC UTILITY PURPOSES, AND LATROBE ROAD.

THE BOARD, AT THIS TIME, REJECTS ALL OTHER OFFERS OF DEDICATION, INCLUDING ROAD OR ACCESS EASEMENTS, APPEARING ON THIS MAP. SUCH OFFERS MAY BE ACCEPTED BY RESOLUTION OF SAID BOARD AT ANY TIME HEREAFTER.

DATE: 11-15-13

[Signature]
JENNIFER BURNS
CLERK OF THE BOARD OF SUPERVISORS

BY: _____
DEPUTY

COUNTY SURVEYOR'S STATEMENT

I HAVE EXAMINED THIS PARCEL MAP. THE SUBDIVISION AS SHOWN HEREON IS SUBSTANTIALLY THE SAME AS IT APPEARED ON THE TENTATIVE MAP, IF ANY, AND ANY APPROVED ALTERATIONS THERETO. ALL PROVISIONS OF THE SUBDIVISION MAP ACT AND OF ANY LOCAL ORDINANCES APPLICABLE AT THE TIME OF APPROVAL OF THE TENTATIVE MAP, IF ANY, HAVE BEEN COMPLIED WITH. I AM SATISFIED THE MAP IS TECHNICALLY CORRECT.

DATE: OCTOBER 2, 2013

[Signature]
GEORGE E. ALLEN L.S. 4951
AMADOR COUNTY SURVEYOR
MY LICENSE EXPIRES 12-31-2013

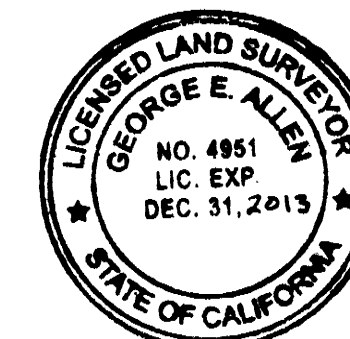

PLANNING DEPARTMENT STATEMENT

I HAVE EXAMINED PARCEL MAP No. 2828 AND HAVE VERIFIED THAT IT IS SUBSTANTIALLY THE SAME AS IT APPEARED ON THE TENTATIVE MAP AND ANY APPROVED ALTERATIONS THERETO.

DATE: Oct. 7, 2013

[Signature]
SUSAN C. GRIJALVA
AMADOR COUNTY PLANNING DIRECTOR

RECORDER'S STATEMENT

FILED THIS 22nd DAY OF November, 2013 AT 10:26 A.M.
IN BOOK 63 OF MAPS AND PLATS AT PAGE 82 AT THE REQUEST OF
THE AMADOR COUNTY CLERK. TITLE TO LAND INCLUDED IN THIS PARCEL MAP BEING
VESTED AS PER CERTIFICATE No. 1102 ON FILE IN THIS OFFICE.

FEE: \$200 pd - filedINSTRUMENT No.: 2013-0010182

[Signature]
KIMBERLY L. GRADY
AMADOR COUNTY RECORDER

BY: *[Signature]*
DEPUTY

NOTARY'S STATEMENT

STATE OF CALIFORNIA
COUNTY OF Sacramento

ON 9-16-13 BEFORE ME, R. Owens, NOTARY PUBLIC,
PERSONALLY APPEARED Gary L. Hawkins and Joan Hawkins
WHO PROVED TO ME ON THE BASIS OF SATISFACTORY EVIDENCE TO BE THE PERSON(S) WHOSE
NAME(S) IS/ARE SUBSCRIBED TO THE WITHIN INSTRUMENT AND ACKNOWLEDGED TO ME THAT
HE/SHE/THEY EXECUTED THE SAME IN HIS/HER/THEIR AUTHORIZED CAPACITY(IES) AND THAT BY
HIS/HER/THEIR SIGNATURE(S) ON THE INSTRUMENT, THE PERSON(S) OR ENTITY UPON BEHALF OF
WHICH THE PERSON(S) ACTED, EXECUTED THE INSTRUMENT.

I CERTIFY UNDER PENALTY OF PERJURY UNDER THE LAWS OF THE STATE OF CALIFORNIA THAT
THE FOREGOING PARAGRAPH IS TRUE AND CORRECT.

SIGNATURE: *[Signature]* NAME: R. OwensCOUNTY: Sacramento COMM. EXP.: July 23, 2016

NOTARY'S STATEMENT

STATE OF ~~CALIFORNIA~~ NEBRASKA
COUNTY OF Boys Bluff

ON 9-11-13 BEFORE ME, Jennifer Gannon, NOTARY PUBLIC,
PERSONALLY APPEARED Trish Aberle, Assistant Secretary
WHO PROVED TO ME ON THE BASIS OF SATISFACTORY EVIDENCE TO BE THE PERSON(S) WHOSE
NAME(S) IS/ARE SUBSCRIBED TO THE WITHIN INSTRUMENT AND ACKNOWLEDGED TO ME THAT
HE/SHE/THEY EXECUTED THE SAME IN HIS/HER/THEIR AUTHORIZED CAPACITY(IES) AND THAT BY
HIS/HER/THEIR SIGNATURE(S) ON THE INSTRUMENT, THE PERSON(S) OR ENTITY UPON BEHALF OF
WHICH THE PERSON(S) ACTED, EXECUTED THE INSTRUMENT.

I CERTIFY UNDER PENALTY OF PERJURY UNDER THE LAWS OF THE STATE OF CALIFORNIA THAT
THE FOREGOING PARAGRAPH IS TRUE AND CORRECT.

SIGNATURE: *[Signature]* NAME: Jennifer J. GannonCOUNTY: Boys Bluff COMM. EXP.: 5-22-17