

CORNER RECORD

Agency Index BK 135 PG 74
Document Number CR 14456

City of Berkeley County of Alameda, California
Brief Legal Description City Monument B1246 near 530 The Alameda

CORNER TYPE

COORDINATES (Optional)

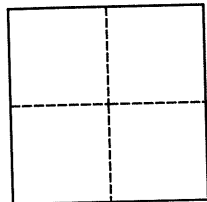

Government Corner ☐ Control ☒
Meander ☐ Property ☐
Rancho ☐ Other ☐

N. _____ E. _____

Elevation _____

Units Metric ☐ U.S. Survey Foot ☐

Horizontal Datum _____

Zone _____ Epoch Date _____

Date of Survey March 16, 2020

Vertical Datum _____

☐ Complies with Public Resources Code §§8801-8819

☐ Complies with Public Resources Code §§8890-8902

PLS Act Ref.:

☐ 8765(d)

☒ 8771

☐ 8773

☐ Other:

Corner/
Monument:

☒ Left as found

☐ Established

☐ Rebuilt

☒ Pre-Construction

☐ Found and tagged

☐ Reestablished

☒ Referenced

☐ Post-Construction

Narrative of corner identified and monument as found, set, reset, replaced, or removed:
☒ See sheet #2 for description(s):

Found monument near 530 The Alameda that could be damaged or destroyed by planned water line construction project. Monument was referenced per CR 9759; as shown on page 2. The purpose of this Corner Record is to preserve possible evidence only; no attempt was made to determine the relationship to property, centerline, or right of way lines.
Reference EBMUD Field Book A, Page 125 (Taaning, Lund)

SURVEYOR'S STATEMENT

This Corner Record was prepared by me or under my direction in conformance with
the Professional Land Surveyors' Act on September 2, 2020

Signed [Signature] P.L.S. or R.C.E. No. 8889



COUNTY SURVEYOR'S STATEMENT

This Corner Record was received _____

and examined and filed SEP 29 2020

Signed D. Ian Wilson P.L.S. or R.C.E. No. 7010

Title ALAMEDA COUNTY SURVEYOR

County Surveyor's Comment



BERKELEY

ALAMEDA COUNTY

530 THE ALAMEDA
APN 62-2903-5

THE ALAMEDA

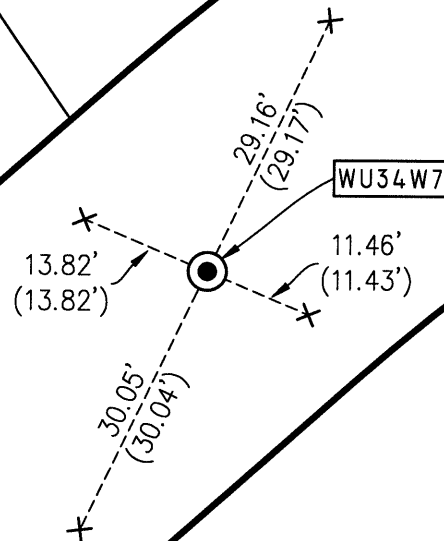

LEGEND



FOUND 2" BRASS DISC WITH PUNCH STAMPED "CITY OF BERKELEY UNLAWFUL TO DEFACE LS 5003 B1246" IN MONUMENT WELL.



FOUND CUT CROSS IN CONCRETE PER CR 9759.



RP DISTANCE, PER CR 9759.

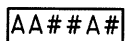

ALAMEDA COUNTY MONUMENT DESIGNATION.



SCALE
1"=20'

ADDRESS: 530 THE ALAMEDA

APN: 62-2903-5