

# CORNER RECORD

BK 72 PG 61  
Document Number CR 7547

City of OAKLAND County of ALAMEDA, California  
Brief Legal Description EAST LINE LOT 9, BLOCK E, 20 MAPS 33

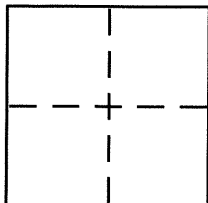

## CORNER TYPE

Government Corner ☐ Control ☐  
Meander ☐ Property ☒  
Rancho ☐ Other ☐  
Date of Survey 8/27/15

## COORDINATES (Optional)

N. \_\_\_\_\_  
E. \_\_\_\_\_  
Zone \_\_\_\_\_ NAD27 ☐ NAD83 ☐  
NAD83 Epoch \_\_\_\_\_  
Elev. \_\_\_\_\_  
Vert. Datum: NGVD29 ☐ NAVD88 ☐  
Meas. Units: Metric ☐ Imperial ☐

Corner – Left as found ☐ Found and tagged ☐ Established ☒ Reestablished ☐ Rebuilt ☐

Identification and type of corner found: Evidence used to identify or procedure used to establish or reestablish the corner:

FOUND STREET MONUMENTS AS PER 133 P.M. 18.

A description of the physical condition of the monument as found and as set or reset:

SET 3/4" x 24" IRON PIPES WITH PLASTIC CAP  
STAMPED "TURNROSE L.S. 7454" & NAIL & WASHER  
STAMPED "TURNROSE L.S. 7454"

## SURVEYOR'S STATEMENT

This Corner Record was prepared by me or under my direction in conformance with

the Land Surveyor's Act on SEPTEMBER 5, 2015

Signed Michael T. Turnrose (P.L.S. or R.C.E. No. 7454)

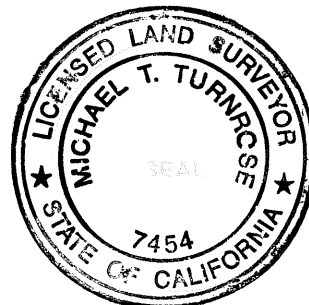

## COUNTY SURVEYOR'S STATEMENT

This Corner Record was received 9-18-15

and examined and filed 9-28-15

Signed Russell R. Penland P.L.S. or R.C.E. No. 5726

Title COUNTY SURVEYOR

County Surveyor's Comment \_\_\_\_\_

