

SECTION

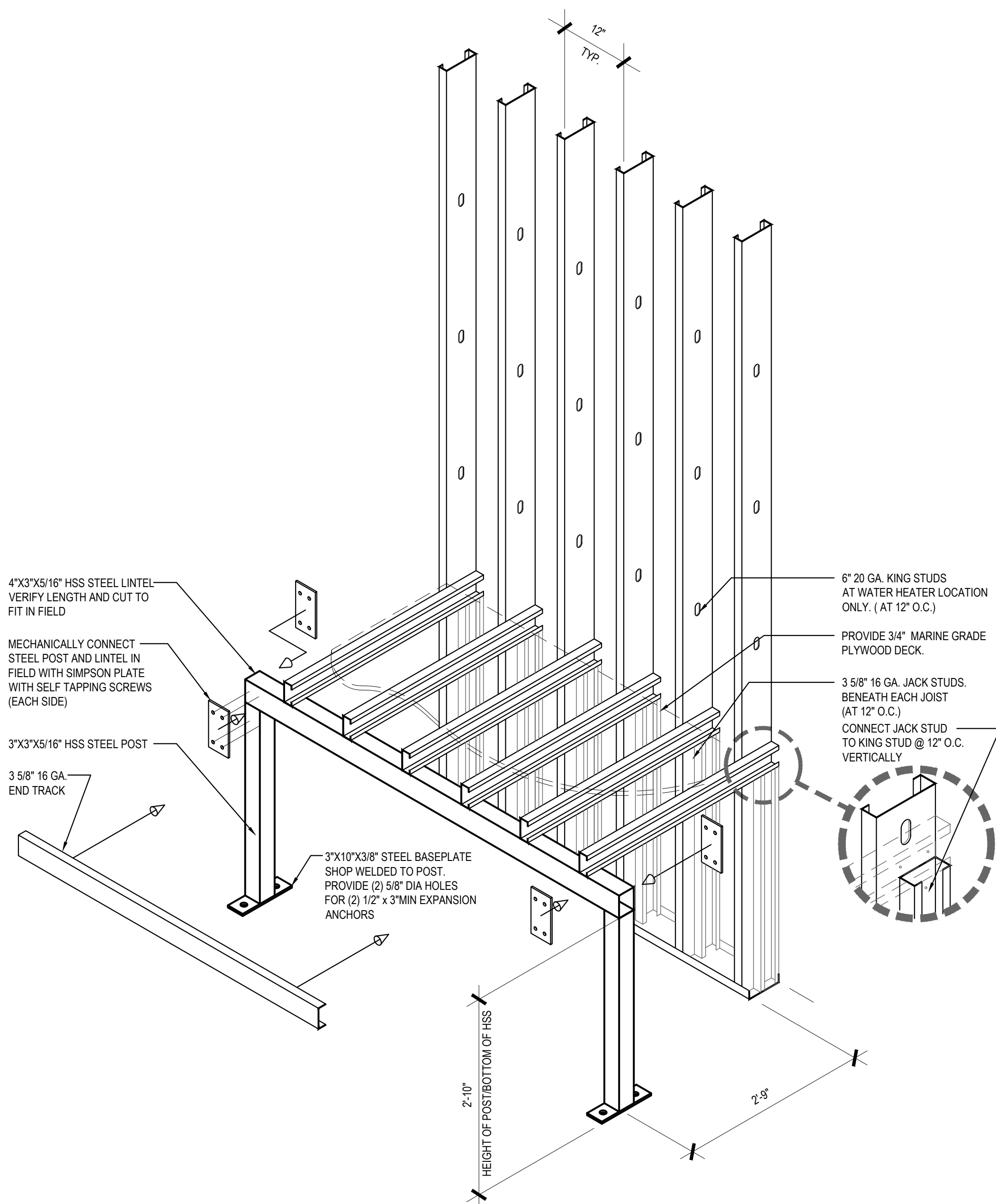

FRAMING

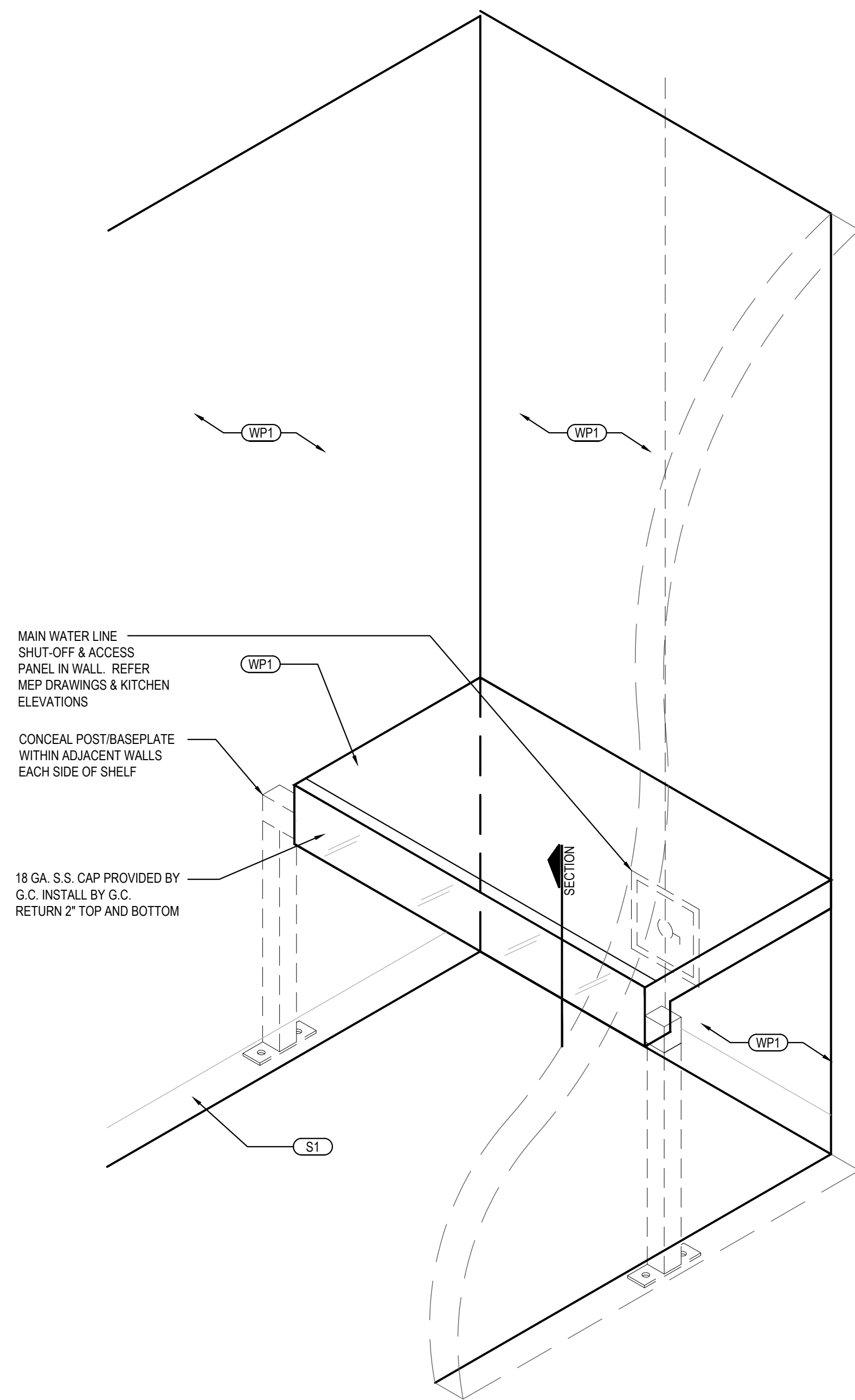

FINISHES



PANDA EXPRESS, INC.
1683 Walnut Grove Ave.
Rosemead, California
91770
Telephone: 626.799.9898
Facsimile: 626.372.8288

All ideas, designs, arrangement and plans indicated or represented by this drawing are the property of Panda Express Inc. and were created for use on this specific project. None of these ideas, designs, arrangements or plans may be used by or disclosed to any person, firm, or corporation without the written permission of Panda Express Inc.

REVISIONS:

REV.	LDH COMMENTS	12-16-2021
Δ	DRIVE THRU REVISION	01-14-2022

ISSUE DATE:

PERMIT/BID ISSUE	09-20-2021
PERMIT/BID ISSUE	01-20-2022

DRAWN BY:

PANDA PROJECT #: - S8-21-D8118
PANDA STORE #: - D8118
ARCH PROJECT #: - 20185

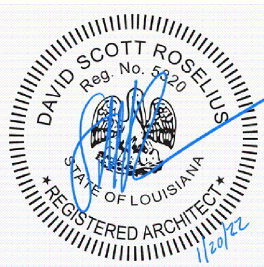

Heights Venture
ARCHITECTURE • DESIGN

HOUSTON 1111 North Loop West, Suite 800 Houston, Texas 77008 713 869 1103 V
DALLAS 5741 Legacy Drive, Suite 320 Plano, Texas 75024 972 490 7292 V

PANDA EXPRESS

TRUE WARM & WELCOME
901 N. SERVICE RD. E.
RUSTON, LA 71270

A-408

WATER HEATER SHELF
DETAILS