

CORNER RECORD

Document Number CR 7312

City of Livermore County of Alameda, California

Brief Legal Description LOT 4, TRACT 6529, filed 7/29/93, 209 Maps, 36:37

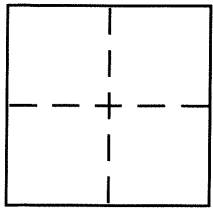

CORNER TYPE

Government Corner ☐ Control ☐
Meander ☐ Property ☒
Rancho ☐ Other ☐
Date of Survey April 01, 2015

COORDINATES (Optional)

N. _____
E. _____
Zone _____ NAD27 ☐ NAD83 ☐
NAD83 Epoch _____
Elev. _____
Vert. Datum: NGVD29 ☐ NAVD88 ☐
Meas. Units: Metric ☐ Imperial ☒

Corner – Left as found ☐ Found and tagged ☐ Established ☒ Reestablished ☐ Rebuilt ☐

Identification and type of corner found: Evidence used to identify or procedure used to establish or reestablish the corner:

Held record relationship of line surveyed with
monuments shown found in Rutgers Court as
shown per map of Tract 6529.
(see page 2)

A description of the physical condition of the monument as found and as set or reset: see Legend
(page 2)

SURVEYOR'S STATEMENT

This Corner Record was prepared by me or under my direction in conformance with

the Land Surveyor's Act on April 20, 2015

Signed Gordon Lee Glenn P.L.S or R.C.E. No. 5666

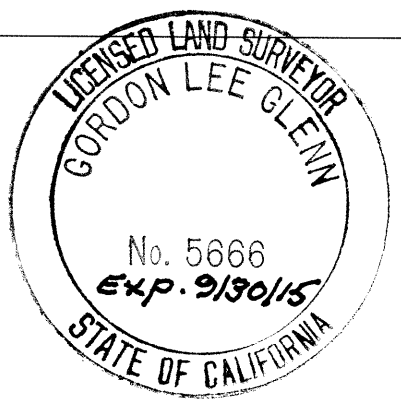

COUNTY SURVEYOR'S STATEMENT

This Corner Record was received 5.21.15

and examined and filed 6.19.15

Signed Russell R. Penland P.L.S or R.C.E. No. 5726

Title COUNTY SURVEYOR

County Surveyor's Comment _____

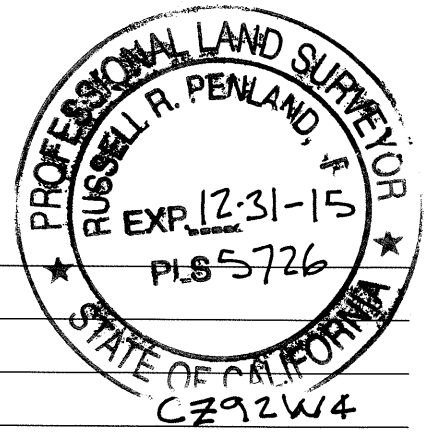

PARCEL MAP 3555
137 M 51

